

# E120W1050, E120W1050-D

(90W, 1050mA, D=Dimmable)

2601 Wayne Street, Endicott, NY 13760 • www.ERGLighting.com • 1-800-215-5866



## FEATURES

Universal Input	120 to 277VAC
High Efficiency	>92%
High Reliability	5-year warranty
Approvals	UL-E341875
Environmental	RoHS & REACH

## Typical Electrical Specifications (Tested @ 120VAC and full load)

Output Power (W)	Output Voltage (V)	Output Current (A)	Efficiency	Frequency	Max. THD (%)	Min. Power Factor
90	60-80	1.05	92%	50/60Hz	10	0.97

## Wiring Diagram

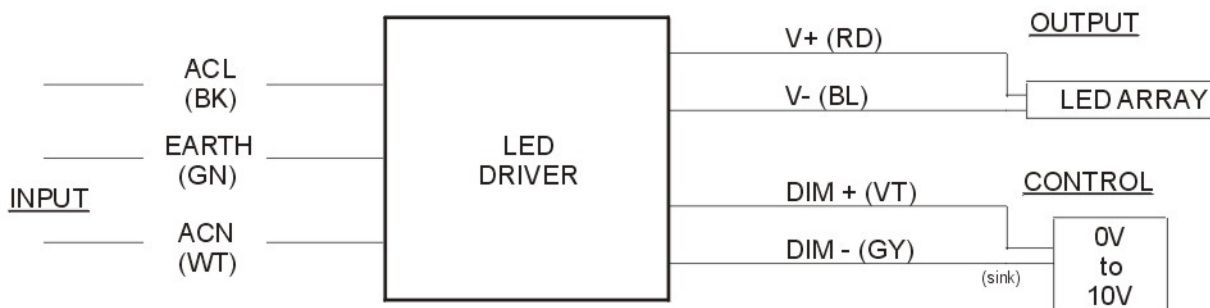

Input and Output use lead-wires.  
 Lead-wires are 18AWG 105°C/600V copper.  
 Dimming use lead-wires.  
 Lead-wires are 24AWG 90°C/600V copper.  
 Non-Dimming Version does not have control wires.

## E120W1050, E120W1050-D

(90W, 1050mA, D=Dimmable)

2601 Wayne Street, Endicott, NY 13760 • www.ERGLighting.com • 1-800-215-5866

### Input Specifications (Note 1)

<b>Input Voltage Range</b>	108VAC—305VAC	<b>Leakage Current</b>	<.5mA
<b>Frequency Range</b>	47 - 63 Hz	<b>Stand-by Power (Note 2)</b>	<1W
<b>Input Current Typical (full load)</b>		<b>Power Factor</b>	0.97 Min
120 VAC	0.9A (RMS)	<b>Total Harmonic Distortion</b>	.1 Max
220 VAC	0.46 (RMS)		
277 VAC	0.36A (RMS)		

### Output Specifications

<b>Efficiency</b>		<b>Voltage</b>	60-80VDC
120 VAC (full load)	92%	<b>Current</b>	1.05A +/- 5%
230 VAC (full load)	93%		
277 VAC (full load)	93%		

### Safety & Environmental Specifications

<b>Safety</b>	UL1012, UL8750 E341875	<b>Storage Temperature</b>	-40°C to 80°C
<b>EMI</b>	FCC Part 15 Class A EN61000-4-3, 4-4, 4-5 (Pending)	<b>Short-Circuit Protection</b>	
<b>Isolation</b>	Isolated (Non Class 2)	<b>Output Over Current Protection</b>	
<b>Operating Ambient Temperature</b>	-30°C to 70°C	<b>Output Over Voltage Protection</b>	
		<b>Over Temperature Protection</b>	

### Mechanical Specifications

<b>Size</b>	6.87" x 3.07" x 1.70" (174.5 x 77.9 x 43.2mm)
<b>Weight</b>	2.592lb (1.176Kg)
<b>Wire Lead Length(s)</b>	18" (457.2mm)

### Notes

1. All specifications are typical at 120VAC input and 25°C with full load, unless otherwise specified.
2. Measured at 120VAC, 0% brightness.

### Performance Characteristics

Efficiency vs. Load

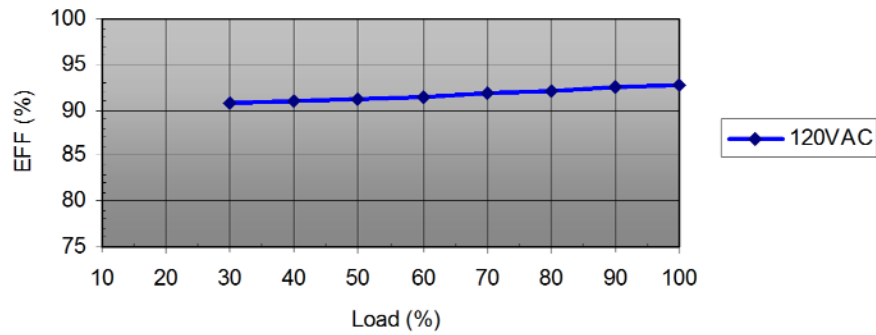

PF vs. Load

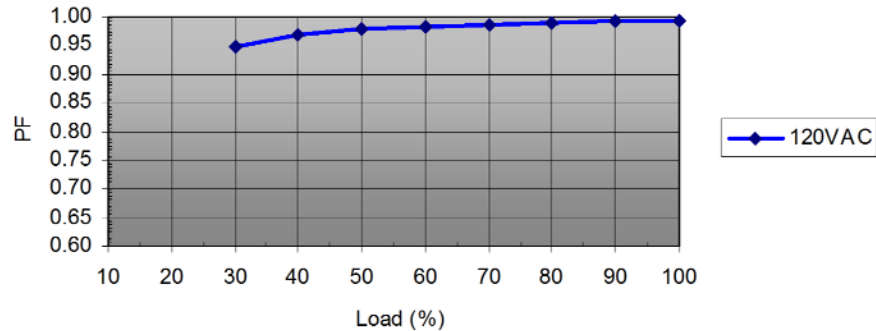

THD vs. Load

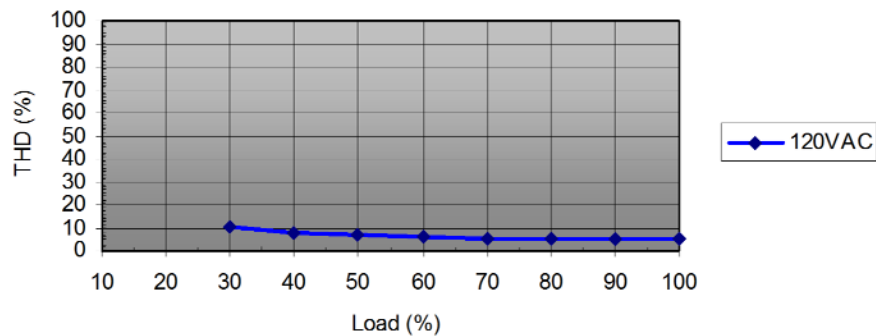

## Dimming

### Dimming Characteristics

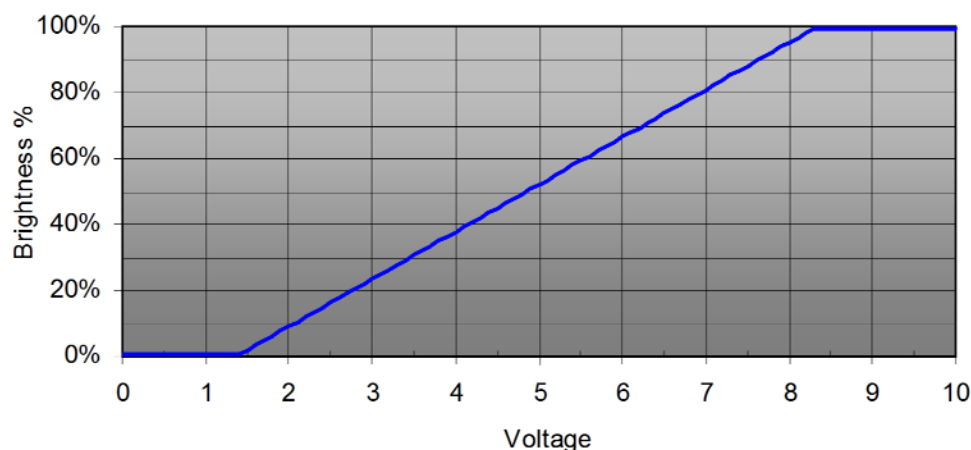

## Dimming Control

Parameter	Min.	Typ.	Max.	Notes
Absolute maximum voltage on the 0~10 V input pin	0 V	-	12 V	
Source current on 0~10 V input pin	0 $\mu$ A	-	1 mA	

The dimmer control may be operated from either potentiometer or from an input signal of 0~10 Vdc.

Do not connect Dim- (GREY) wire with V- (BLUE) wire.



**DuraLume**  
*Driving Your Vision*  
 A division of Endicott Research Group, Inc.

# E120W1050, E120W1050-D

(90W, 1050mA, D=Dimmable)

2601 Wayne Street, Endicott, NY 13760 • www.ERGLighting.com • 1-800-215-5866

## Mechanical Dimensions

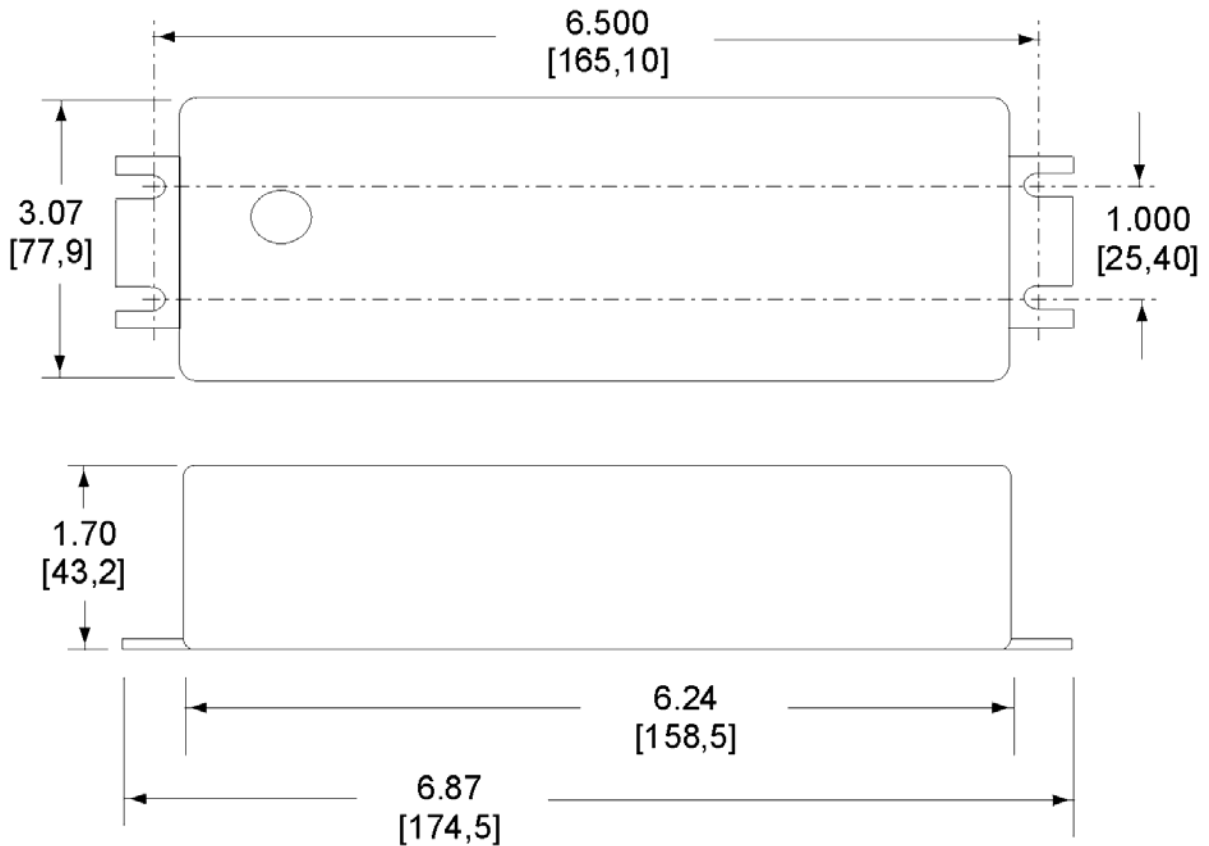

Endicott Research Group, Inc (ERG) reserves the right to make changes in circuit design and/or Specifications at any time without notice. Accordingly, the reader is cautioned to verify that data sheets are current before placing orders. Information furnished by ERG is believed to be accurate and reliable. However, no responsibility is assumed by ERG for its use.